

# Quick Set-Up Guide for 7845GSM/7845i-GSM Modules

## Step 1 Check Signal Strength

- A** Connect AC transformer
- B** Plug in the transformer to an available AC source
- C** Check that signal strength is at least 3-5 bars lit solid at mounting location

### Signal Strength (RSSI) Function LED Display

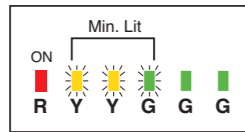

- D** Unplug the transformer

## Step 2 Mount

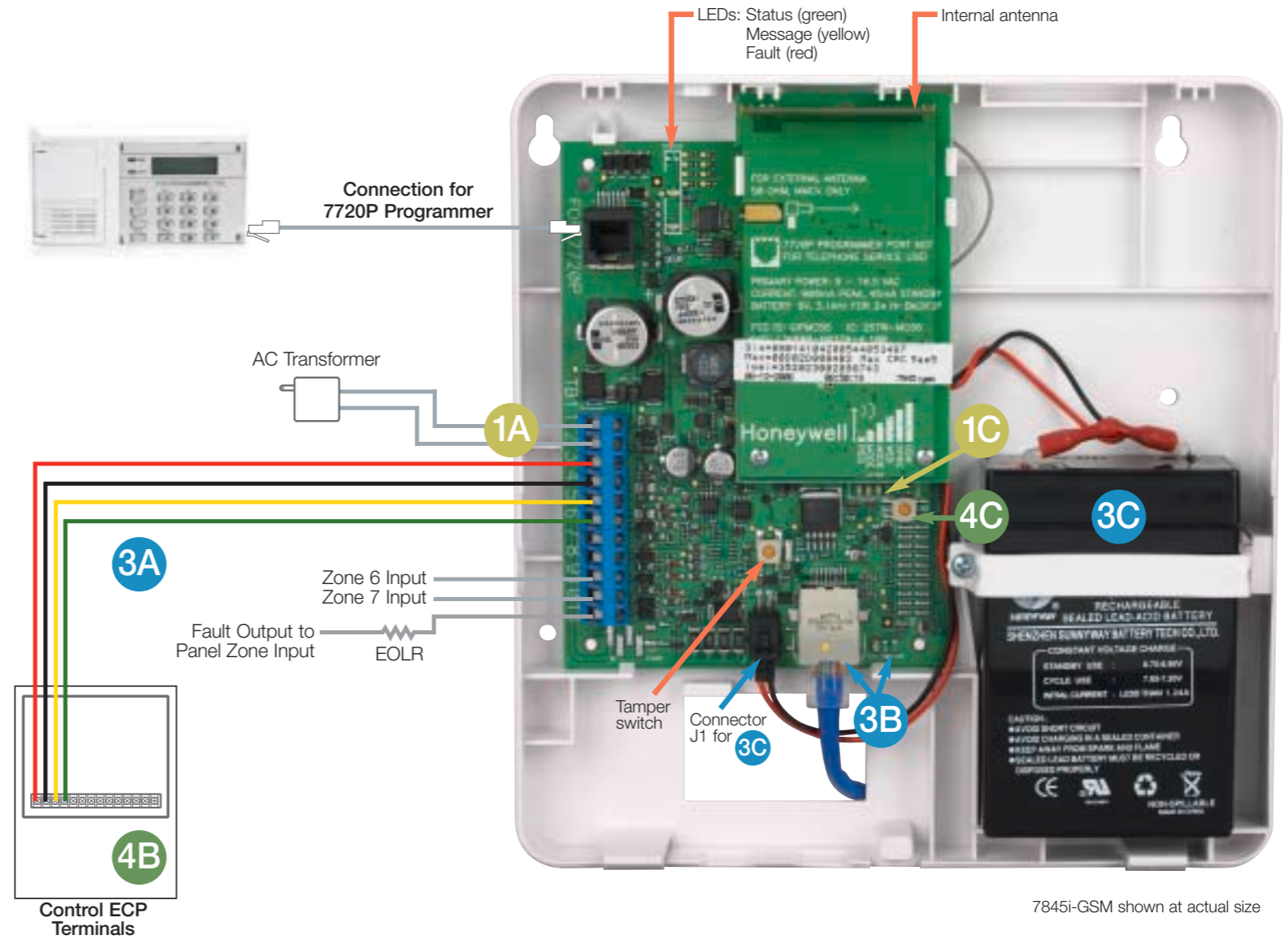
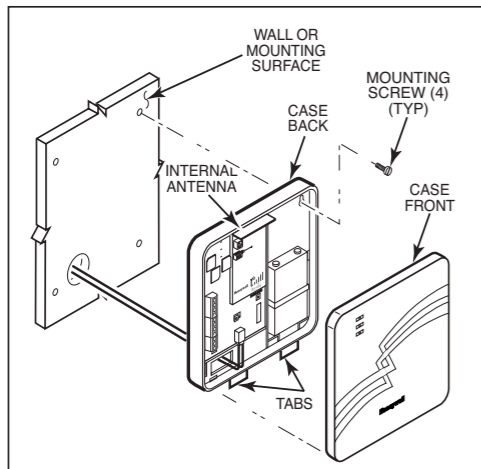

7845i-GSM shown at actual size

## Step 3 Wire

- A** Connect control panel wiring
  - 12VDC in (red)
  - GND (black)
  - ECP input (yellow)
  - ECP output (green)
- B** 7845i-GSM only – Connect Ethernet port to router – the Ethernet has been detected when the right-most LED is lit in the network connectivity LCD display
- C** Place the battery inside the case back
  - Snap the battery clip onto the right side of the case back and secure the left side with the screw provided
  - After all wiring connections have been made, connect battery cables to the battery terminals
  - Connect battery cable to connector J1

## Step 4 Power Up and Program

- A** Plug in transformer to a 120V AC source
- B** Power up control panel
- C** Check that module is in ECP mode. Press and hold RSSI/Mode status switch. Red LED and both Yellow LEDs should be off. (Refer to Installation and Setup Guide if using any other mode)

### RSSI/Mode Status Indicator Switch



- D** Use the web-based programming tool on the AlarmNet Direct website or the 7720P Programmer to complete programming (see Installation and Setup Guide for instructions)

## Step 5 Register

- All Honeywell GSM modules are pre-activated with the cellular carrier
- The GSM module requires an AlarmNet-i account and may be registered by one of the following methods:
  - Via web-based programming on <https://services.alarmnet.com/alarmnetdirect>
  - Via 7720P Programmer
  - By calling AlarmNet Technical Assistance at 1-800-222-6525
- When replacing 7845C series modules, registration may be done by entering a PIN number
- See Installation and Setup Guide for complete instructions

**Honeywell**